



## SERVICE INSTRUCTIONS SERIES 152 Half-Mask Supplied Air Respirator Type C Continuous Flow



### Caution:

- Thoroughly read the service instructions for the use and maintenance of this respirator.
- 2 This respirator is to be used only by qualified, trained personnel.
- 3. Thoroughly inspect the respirators prior to use.
- 4 Never wear this respirator in any atmosphere immediately dangerous to life or health. Never use this unit in an atmosphere from which the wearer cannot escape without respiratory equipment.

Adequate respiratory protection must include hazard assessment, selection and proper usage, instruction and training, maintenance, inspection and replacement, and approval agency identification.

### Warning:

1. Never modify or alter this respirator; any modification or part substitutes void the approval.
2. Never use this respirator as an underwater device.
3. This device may not provide a satisfactory facesal with certain physical characteristics (such as beards and gross sideburns), as outlined in ANSI Z88.2-1969, resulting in leakage in connection with the facepiece, which voids or limits the protection. If such a condition exists, the user assumes all risks of death or serious bodily injury which may possibly result.
4. Use strictly in accordance with the instructions, labels, and limitations pertaining to this device

### AIR SUPPLY

Respirable air must meet at least the requirements of Type I, Grade D breathing air as described in American National Standard Commodity Specification for Air Z 86.1-1973.

This respirator is designed to be supplied continuously with respirable air from a suitable source provided by the purchaser. The wearer of the respirator breathes the supplied air rather than the air in the immediate vicinity.

### Air Supply Hose -

This respirator must be supplied with respirable air through any one or combination of the following air supply hoses which do not exceed 300 feet in length:

Part No. 152-25  
Part No. 152-50

- 25 Foot Air Supply Hose  
- 50 Foot Air Supply Hose

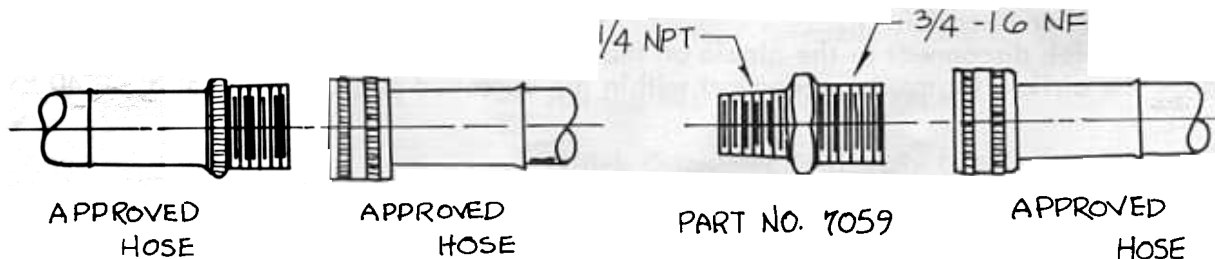

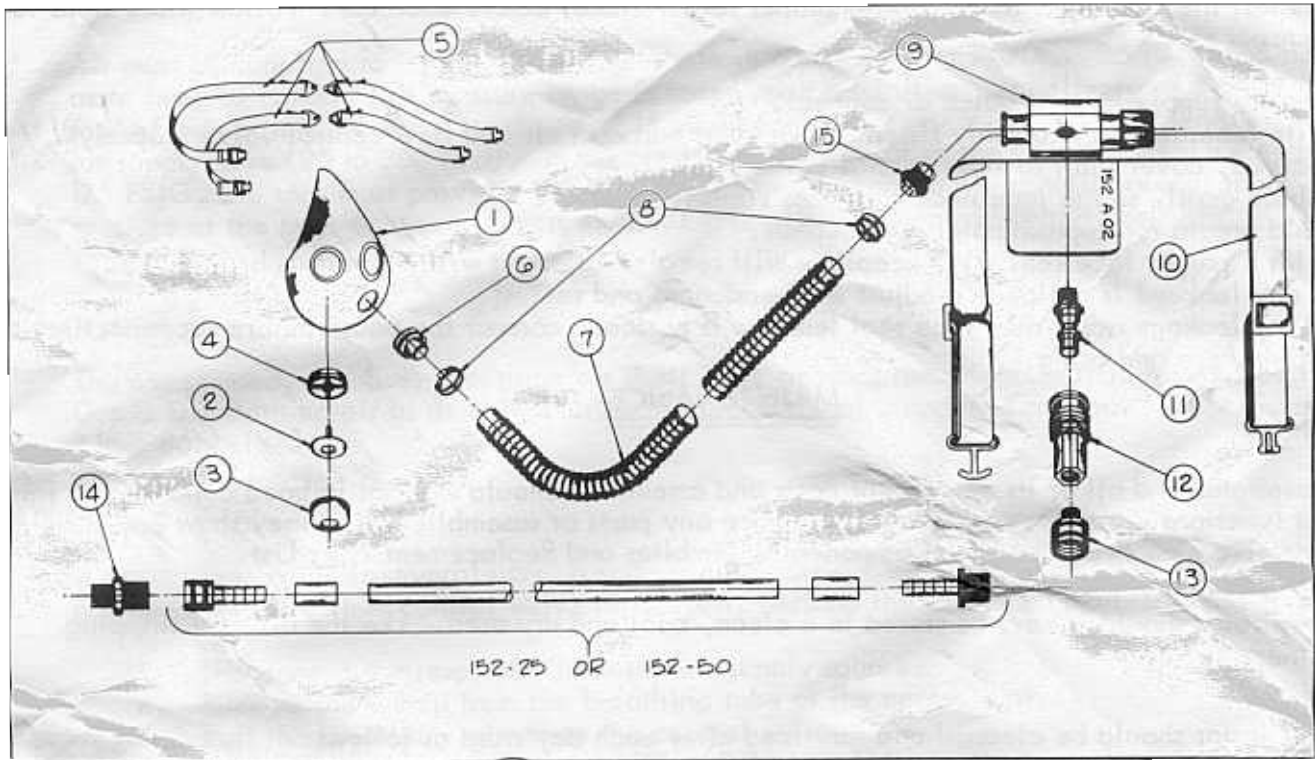

<u>Item No.</u>	<u>Catalog Number</u>	<u>Description</u>
	159-A-00	Basic Facepiece
2	159-A-05	Exhalation Valve Diaphragm (4 per pkg.)
3	159-A-08	Exhalation Valve Cover
4	159-T-57	Exhalation Valve Seat
5	159-T-55	Headbands (set of 4)
6	159-A-01	Breathing Tube Connector
7	159-A-02	Breathing Tube
8	159-A-03	Breathing Tube Clamp
9	159-A-04	Control Valve (with plate and screws)
11	159-A-06	Male Quick Disconnect Coupling
12	159-A-07	Female Quick Disconnect
13	159-A-10	Hose Fitting, 1/4" MPT x Female 3/4 - 16NF
14	7059	Hose Fitting, 1/4" MPT x Male 3/4-16NF
15	159-A-11	Muffler

**NOTES:**

Replacement 'O' rings for the Main Air Supply Hose couplings are available in packages of two, Part No. 7053.

- One Part No. 7059 is supplied with each 152 Respirator, complete. Specify number desired if ordering Main Air Supply Hoses only.

**U.S. SAFETY**

8101 Lenexa Drive P.O. Box 15965  
 Lenexa, Kansas 66285-5965 913-599-5555